



ZODIAC®

INSTALLATION MANUAL



eXO®
(all models)



Clearwater Duo™
(all models)

WARNING

FOR YOUR SAFETY - This product must be installed and serviced by a licensed electrician in accordance with the latest enforced version of AS/NZ 3000 and any other applicable local installation codes. Before installing this product, read and follow all warning notices and instructions that accompany this product. Failure to follow warning notices and instructions may result in property damage, personal injury, or death. Improper installation and/or operation will void the warranty.

Improper installation and/or operation can create unwanted electrical hazard which can cause serious injury, property damage, or death.

Refer to the following websites for information on warranty and service in your country:

- Australia, NZ, Asia and Sth Pacific go to www.zodiac.com.au
- South Africa go to www.zodiac.co.za

EQUIPMENT INFORMATION RECORD	
DATE OF INSTALLATION _____	
INSTALLER INFORMATION _____	
INITIAL PRESSURE GAUGE READING (WITH CLEAN FILTER) _____	
PUMP MODEL _____	HORSEPOWER _____
FILTER MODEL _____	_____
CONTROL PANEL MODEL _____	SERIAL NUMBER _____
NOTES: _____	

Table of Contents

<p>Section 1. Important Safety Instructions 4</p> <p>Section 2. System Overview 6</p> <p>2.1 Contents6</p> <p>2.2 Specifications6</p> <p>2.3 Dimensions.....7</p> <p>2.4 Materials and Tools7</p> <p>Section 3. Plumbing..... 8</p> <p>Section 4. Install Controller 9</p> <p>4.1 Mount the Bracket9</p> <p>4.2 Install temperature sensor.....9</p> <p>4.3 Electrical Connections.....9</p> <p>Section 5. Install the pH Link or Dual Link Module on the Controller 11</p> <p>5.1 Install the POD Kit..... 11</p> <p>5.2 Drill the Pipe 11</p> <p>5.3 Install the POD 11</p> <p>5.4 Install the POD Cap..... 12</p> <p>5.5 Install and Calibrate the Sensor(s)..... 12</p> <p>5.6 Install the pH Down Intake and Injection lines..... 13</p> <p>5.7 Calibration Procedure..... 14</p> <p>Section 6. Prepare and Balance the Pool 15</p> <p>6.1 pH Regulation Principle..... 15</p> <p>6.2 Water Chemistry Table 15</p> <p>6.3 Stabilizer (Cyanuric Acid) 15</p> <p>Section 7. Operation 16</p> <p>7.1 User Interface Overview..... 16</p> <p>7.2 Initial start-Up 16</p>	<p>Section 8. Installing and Assigning Equipment 18</p> <p>8.1 Filter Pump 18</p> <p>8.2 Aux/Lights..... 19</p> <p>8.3 Heating 21</p> <p>Section 9. Calibration and Priming 22</p> <p>9.1 pH Sensor Calibration 22</p> <p>9.2 ORP Sensor Calibration 22</p> <p>9.3 Setpoint(s)..... 22</p> <p>9.4 Prime and Test the pH Dosing Pump 23</p> <p>9.5 Programming/Timers..... 23</p> <p>9.6 Reversing 25</p> <p>9.7 Slave Mode 25</p> <p>Section 10. Pairing and Connecting to Wi-Fi 26</p> <p>10.1 Wi-Fi Direct Mode..... 26</p> <p>10.2 Invitation Code 26</p> <p>10.3 Frequently Asked Wi-Fi Connection Questions (FAQs)26</p> <p>Section 11. Help Menu..... 27</p> <p>Section 12. Inspecting and Cleaning the Electrode 28</p> <p>Section 13. Winterizing..... 28</p> <p>13.1 Winterize the pH/ORP Sensors..... 28</p> <p>13.2 Reopening the Pool..... 28</p> <p>Section 14. Troubleshooting..... 29</p>
---	---

Section 1. Important Safety Instructions

READ AND FOLLOW ALL INSTRUCTIONS

All electrical work must be performed by a licensed electrician and conform to all national, state, and local codes. When installing and using this electrical equipment, basic safety precautions should always be followed, including the following:

⚠ DANGER

To reduce the risk of severe injury or death, do not remove the suction fittings of your spa or hot tub. Never operate a spa or hot tub if the suction fittings are broken or missing. Never replace a suction fitting with one rated less than the flow rate marked on the equipment assembly.

⚠ WARNING

Prolonged immersion in hot water may induce hyperthermia. Hyperthermia occurs when the internal temperature of the body reaches a level several degrees above the normal body temperature of 37°C. The symptoms of hyperthermia include dizziness, fainting, drowsiness, lethargy, and an increase in the internal temperature of the body. The effects of hyperthermia include: 1) unawareness of impending danger; 2) failure to perceive heat; 3) failure to recognize the need to exit spa; 4) physical inability to exit spa; 5) fetal damage in pregnant women; 6) unconsciousness resulting in a danger of drowning.

⚠ WARNING

To Reduce the Risk of Injury -

- a) The water in a spa should never exceed 40°C. Water temperatures should remain between 38°C and 40°C. The water in a spa should never exceed 40°C. Water temperatures between 38°C and 40°C are considered safe for a healthy adult. Lower water temperatures are recommended for young children and when spa use exceeds 10 minutes.
- b) Since excessive water temperatures have a high potential for causing fetal damage during the early months of pregnancy, pregnant or possibly pregnant women should limit spa water temperatures to 38°C. Before entering a spa or hot tub, the user should measure the water temperature with an accurate thermometer since the tolerance of water temperature-regulating devices varies.
- d) The use of alcohol, drugs, or medication before or during spa or hot tub use may lead to unconsciousness with the possibility of drowning.
- e) Obese persons and persons with a history of heart disease, low or high blood pressure, circulatory system problems, or diabetes should consult a physician before using a spa.
- f) Persons using medication should consult a physician before using a spa or hot tub since some medication may induce drowsiness while other medication may affect heart rate, blood pressure, and circulation.

⚠ WARNING

Risk of electric shock - Install the controller at least 3.5 metres from the inside wall of the pool and/or hot tub using non-metallic plumbing.

Children should not use spas or hot tubs without adult supervision.

Do not use spas or hot tubs unless all suction guards are installed to prevent body and hair entrapment.

People using medications and/or having an adverse medical history should consult a physician before using a spa or hot tub.

⚠ WARNING

To avoid injury ensure that you use this control system to control only packaged pool/spa heaters which have built-in operating and high limit controls to limit water temperature for pool/spa applications. This device should not be relied upon as a safety limit control.

⚠ WARNING

People with infectious diseases should not use a spa or hot tub.

To avoid injury, exercise care when entering or exiting the spa or hot tub.

Do not use drugs or alcohol before or during the use of a spa or hot tub to avoid unconsciousness and possible drowning.

Before entering a spa or hot tub, measure the water temperature with an accurate thermometer.

Do not use a spa or hot tub immediately following strenuous exercise.

Prolonged immersion in a spa or hot tub may be injurious to your health.

Do not permit any electric appliance (such as a light, telephone, radio, or television) within 3.5 metres of a spa or hot tub.

The use of alcohol, drugs or medication can greatly increase the risk of fatal hyperthermia in hot tubs and spas.

Water temperature in excess of 38°C may be hazardous to your health.

⚠ WARNING

A terminal bar marked "GROUND" is provided within the controller. To reduce the risk of electrical shock which can cause serious injury or death, connect this terminal bar to the grounding terminal of your electric service or supply panel with a continuous copper conductor having green insulation and one that is equivalent in size to the circuit conductors supplying this equipment in accordance with AS/NZ 3000 - 2007. In addition, where required, bonding should be extended in accordance with AS/NZ 3000 - 2007 to any metal ladders, water pipes, or other metal within 3.5 m of the pool/spa.



Attention Installer: Install to provide drainage of compartment for electrical components.

SAVE THESE INSTRUCTIONS

Section 2. System Overview

2.1 Contents

Before starting, check that you have the correct parts as indicated in Table 1. If any parts are missing or incorrect, please call your local distributor or technical support at 1300 763 021 for assistance.

2.1.1 Salt Chlorinator System



Clearwater, eXO®, Hydroxinator (all models)			
a.	Controller		
b.	Temperature Sensor*		
c.	Wall Mount Bracket		
d.	Wall Mount Screws Ø7 mm (X2)		
e.	Wall Mount Anchor (X2)		
f.	Electrolytic Cell		
g.	Unions (X2)		
h.	Glue on Adapter (X2)		
i.	Adapter O-Rings (X2)		
j.	Pipe Reducer - White (X2)		
k.	Zip Ties (X7) - (not shown)		

*Items not included with all models.

Table 1. Salt Chlorinator System Contents

2.2 Specifications

2.2.1 Salt Chlorinator System

	Compact	Mid	Large
Nominal chlorine production	18 g/h	25 g/h	35 g/h
Nominal output amps	3.6 A	5.0 A	7.2 A
Required salt level	4000ppm		
Power supply voltage	240 VAC - 50 Hz		
Electric power	200 W		
Protection index	IP43		
Flow through the cell	Min. 80 Lpm		
Max pressure in the cell	2.75 bar		
Operating water temperature	10°C - 40°C		

Table 3. Salt Chlorinator System Specifications

2.1.2 Water Care Module Contents



pH Link, Dual Link	
a.	Module (pH Link or Dual Link)
b.	POD Housing Upper
c.	POD Housing Lower
d.	40 mm Pipe Adapter
e.	POD Cap
f.	Cap Plug (X2)
g.	pH Injector Valve
h.	Hole Saw and Hex Key
i.	Compression Fitting
j.	Ceramic Weight
k.	6 mm Tube (5 m)
l.	Acid Cap, 5 L
m.	Acid Cap, 15/20 L
n.	Locking Collar
o.	Locking Collar Tool
p.	pH Sensor
q.	ORP Sensor*
r.	Sensor Holder (X2*)

NOTE: Water care modules are optional accessories and will not be included with all models.

*Items only included with eXO® - Pro iQ
 pH Buffer Solutions: pH 7 (X6), pH 4 (X6) - (not shown)
 ORP 470 mV Buffer Solution (X6) - (not shown)

Table 2. Water Care Module System Contents

2.2.2 Water Care Module

Power Supply	Extra low voltage (connected to controller)
Peristaltic pump flow rate	1.2 L/h
Maximum back pressure (injection)	1.5 bar
pH correct	Acidic pH only (sulfuric/hydrochloric acid)
pH sensor calibration	1 or 2 point (pH 4 and pH 7)
Sensor Cable Length	3 Meters
ORP sensor calibration*	1 point (470 mV)

*Applicable only to eXO® - Pro iQ

Table 4. Water Care Module Specifications

2.3 Dimensions

2.3.1 Controller

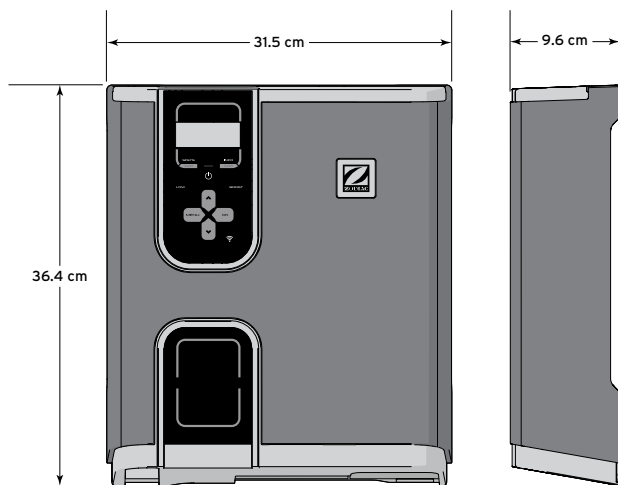

Figure 1. Controller Dimensions

2.3.2 Cell

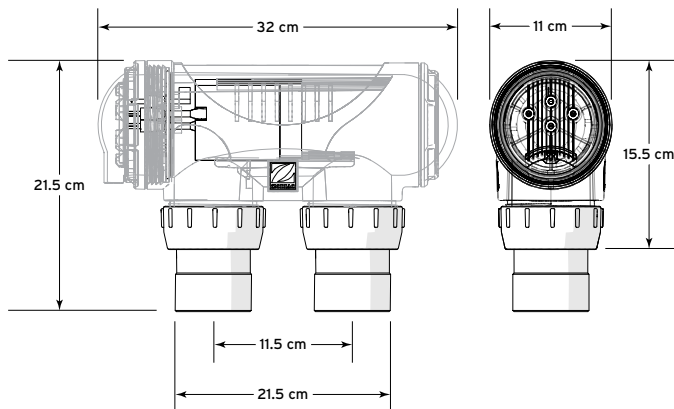

Figure 2. Electrolytic Cell Dimensions

2.4 Materials and Tools

2.4.1 Controller

Tools Needed for Installation

- Power Drill
- 7 mm Drill Bit - Hammer Drill Bit (only necessary to drill into brick or concrete)
- Pencil or Marking Pen
- Flat Head Screwdriver
- Pozidiv Screwdriver
- Small Flathead or Slotted Screwdriver

2.4.2 Cell

Tools Needed for Installation

- PVC Cutter
- PVC Cement
- Pencil or Marking Pen
- Check Valve
- 40 mm or 50 mm PVC pipe

2.4.3 pH ORP POD

Tools Needed for Installation

- Power Drill
- Pencil or Marking Pen
- Flat Head Screwdriver
- Phillips Head Screwdriver
- Small Flathead or Slotted Screwdriver

Section 3. Plumbing

The cell must be plumbed in a position that is accessible for maintenance and within 2 meters of the controller. The cell should be the last piece of equipment in the circulation system. The cell must be installed horizontally, level and with correct flow orientation, see Figure 3 and Figure 4.

1. If you intend to plumb the cell on a bypass, the bypass must be equipped with Isolation valves, see Figure 3 and Figure 4.
2. Plumb the cell inlet and outlet on vertical lengths of 40 mm or 50 mm PVC pipe. The cell inlet and outlet ports are 11.5 cm apart, see Figure 2. The inlet of the cell is on the side closest to the electrical lead, see Figure 5.

3. Put the unions onto the inlet and outlet pipes, see Figure 5.
4. For 50 mm plumbing, glue the adapters directly onto the pipes.
5. For 40 mm plumbing, glue the reducers into the adapters then glue the adapters onto the pipes.
6. Ensure the o-rings are seated properly on the adapters.
7. Secure the cell to the plumbing by tightening the unions hand tight. **DO NOT OVERTIGHTEN.**
8. Double check cell orientation. The cell inlet is closest to the cell electrical lead.

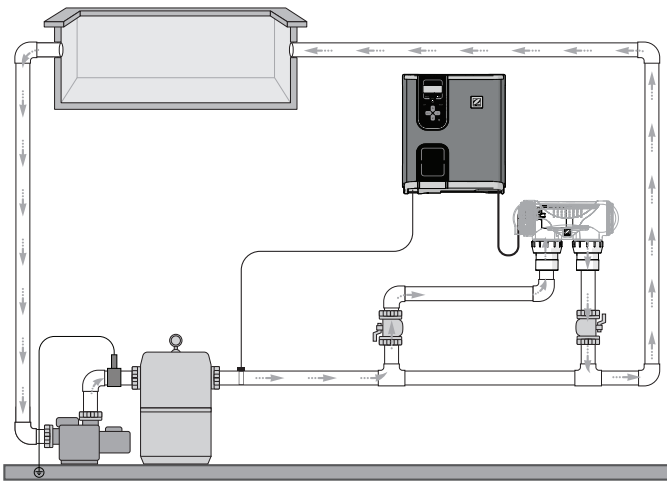

Figure 3. Plumbing Cell Only

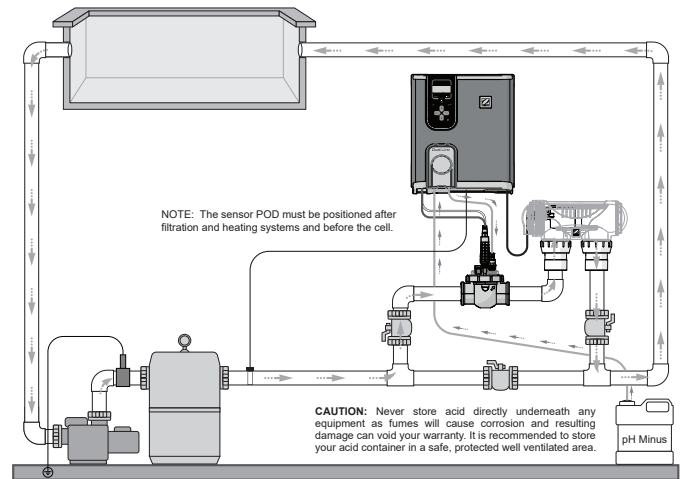

Figure 4. Plumbing Cell and POD assembly



Figure 5. Cell Plumbing Assembly

⚠ WARNING

- The cell must be installed horizontally and level. Improper installation can lead to gas build up which could result in equipment damage or serious injury.
- The cell must be the last piece of equipment on the return line, see Figure 3 and Figure 4.
- It is recommended in all installations that the cell is installed on a bypass equipped with isolation valves, see Figure 3 and Figure 4.
- In order to avoid load loss, installing the cell on a bypass is **MANDATORY** if system flow rated exceeds 300 Lpm, see Figure 3 and Figure 4.
- If installing on a bypass, use a downstream check valve instead of a manual valve to prevent improper back flow into the cell.

Section 4. Install Controller

The controller should be located at or near the equipment pad, at least 3.5 metres or more away from the inside wall of the pool/spa, 1.5 metres off the ground, and within 2 meters of the cell. All national, state, and local codes are applicable.

4.1 Mount the Bracket

1. Determine the controller location.
2. Use the enclosed bracket to mark the mounting surface through the screw holes.
3. Drill surface with 7 mm bit.
4. Install the included wall anchors.
5. Hang bracket using the included screws.
6. Hang the controller on the wall bracket and slide to the right to secure in place.

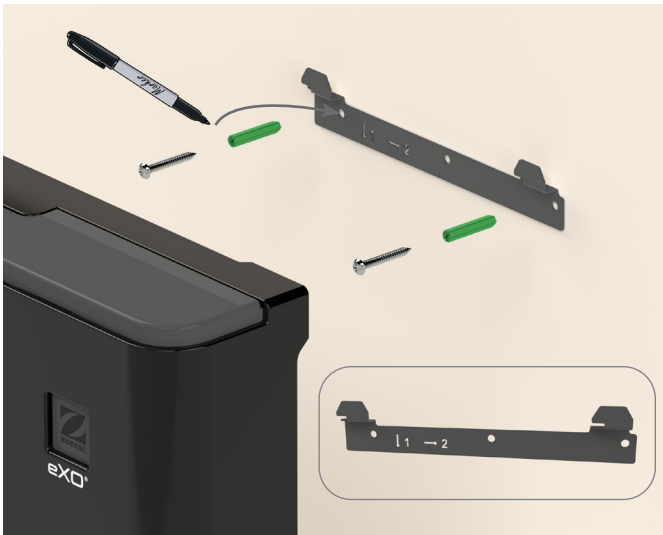

Figure 6. Controller Mount

4.2 Install temperature sensor

The temperature sensor must be installed upstream from any heating equipment, see Figure 3 and Figure 4. The sensor will need to be placed into the plumbing system at any suitable position after the filter pump and before any heating equipment.

1. Drill a Ø9 mm hole in the top of the pipe.
2. Ensure the o-ring is properly seated on the sensor body.
3. Secure the sensor and o-ring with the screw clamp provided. **DO NOT OVERTIGHTEN.**

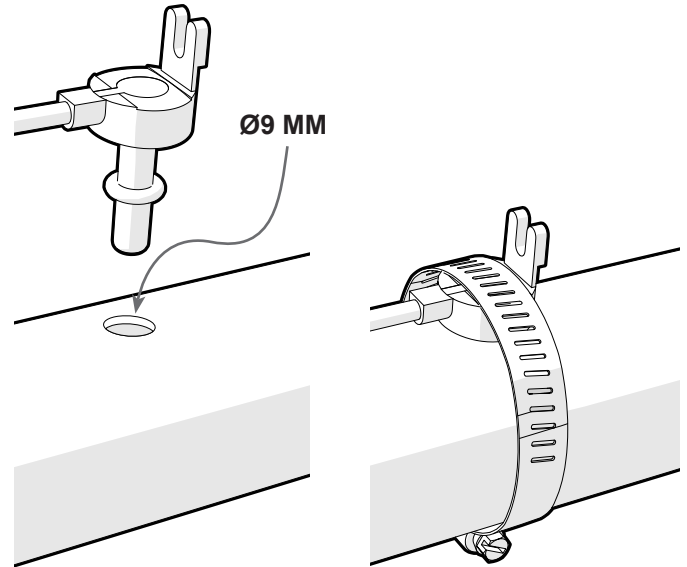

Figure 7. Install Temperature Sensor

4.3 Electrical Connections

⚠ WARNING

FOR YOUR SAFETY: This product must be serviced by a professional pool/spa service technician as described on the front cover of this manual. The procedures in this manual must be followed exactly. Failure to follow warning notices and instructions may result in property damage, serious injury, or death. Improper installation and/or operation will void the warranty.

The controller must be permanently powered by connection to a 30 mA residential circuit breaker.

The controller can be used to connect and control multiple devices see Table 5 for a summary of functions.

4.3.1 Remove Lower Cover

1. Unplug power supply from mains.
2. Remove the external cover.
3. Remove the 2 screws from the lower housing.
4. Remove the lower housing by pulling down then out see Figure 8.

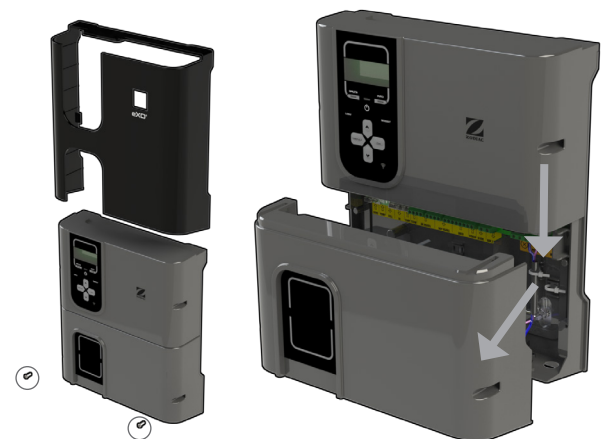

Figure 8. Remove Controller Lower Cover

4.3.2 Controller Enclosure Wiring

1. Wire low voltage connections on the low voltage side of the enclosure, see Figure 10.
2. Wire high voltage connections on the high voltage side of the enclosure, see Figure 10.
3. Use the internal labels (low voltage - yellow, high voltage - orange) to identify connection points.
4. Use the cable ties provided to secure internal wiring to the controller frame. See Figure 10 for recommended cable tie locations and Table 5 for connection point functions.
5. Pass cables through the appropriately labeled strain relief ports. It may be necessary to pierce the strain relief grommet prior to passing the cables through it.

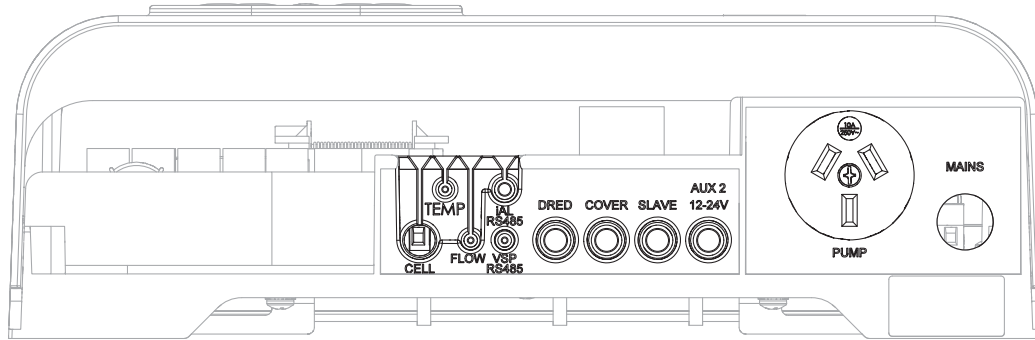

Figure 9. Controller Connection Ports

NAME	TYPE	ROUTE	FUNCTION
SENS	Input	-	Connection of the pH or pH/ORP sensing PCBA
PUMP	Input	-	Connection of the pH pump for pH Link and Dual Link modules
CELL	Output	1	Connection of the electrolysis cell
UI	Output	-	Connection of the user interface
TEMP	Input	3	Connection of the water temperature probe
Flow	Input	2	Not used in AUS / South Africa
iAL RS485	Input	4	Not used in AUS / South Africa
VSP RS485	Output	5	RS485 variable speed pump connection
DRED	Input	6	DRED Functon (Demand Response Enabled Device) – for Australia only
COVER	Input	7	Pool cover contact – lower the chlorine production (dry contact: cover open = open contact/cover closed = closed contact)
SLAVE	Input	8	For use with 3rd party ORP sensor controllers. Do not use with AquaLink or general automation controllers
AUX 2 12-24V	Output	9	ON/OFF control of a LOW VOLTAGE external device (12 – 24V) or a heating system
AUX 1 230V	Output	10	ON/OFF control of a HIGH VOLTAGE device. - Not available in Australia
PUMP 230V	Output	11	230 V Power supply for the filtration pump Maximum 8A
MAINS	Input	12	Device power supply 230 VAC – 50Hz

Table 5. Controller Wiring Positions

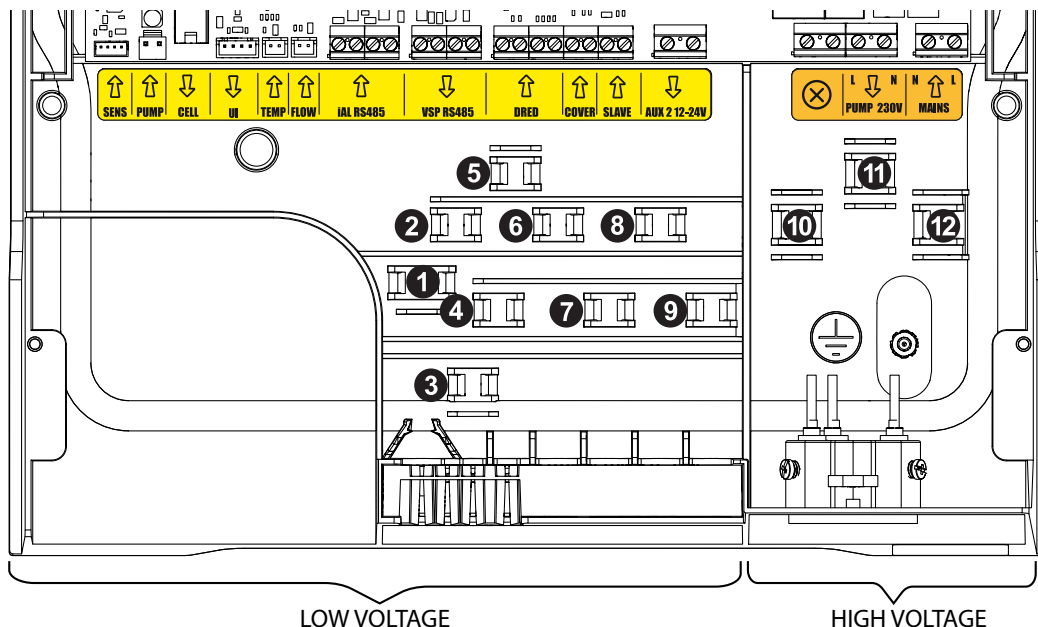

Figure 10. Controller Wiring

Section 5. Install the pH Link or Dual Link Module on the Controller

NOTE: Water care modules are optional accessories and will not be included with all models.

If your controller model does not have a Dual-Link or pH Link module you may skip to Section 6.

The controller must be installed and operational before you install the module, refer to Section 4.

pH balance and suitable alkalinity levels in the water must be maintained. Be sure to prepare and balance the pool before installing the pH Link or Dual Link module, for details see Section 6.

1. ⚠ Turn OFF and disconnect all power to the controller.
2. Remove the front cover from the controller, see section 4.3.1 for details.
3. Connect Sens and Pump wires from the Module to the controller board see section 4.3 for wiring details.
4. Seat the Module housing on the controller.
5. Fasten two screws to secure the module to the controller.
6. Replace the external cover.



Figure 11. Dual Link Module Installed

⚠ WARNING

In order to avoid risk of serious damage to the equipment and/or electrocution which could result in serious injury or death, do not reconnect power supply until all components are installed: (1) pH Link/Dual Link module, (2) POD kit, and (3) pH down injection pipe.

5.1 Install the POD Kit

1. ⚠ Turn off and disconnect all power to the controller.
2. For optimal performance, the POD must be installed:
 - On a 30 cm length of rigid 40 mm or 50 mm PVC pipe.
 - As far as possible from any angles.
 - Horizontally.
 - Vertically within 30°.
 - After the filtering equipment.
 - After any heating device but before the electrolytic cell or other water treatment equipment.

5.2 Drill the Pipe

1. Inspect the POD O-ring to ensure it is in good condition and properly seated.
2. Press tabs to remove the upper POD housing from the lower POD housing.

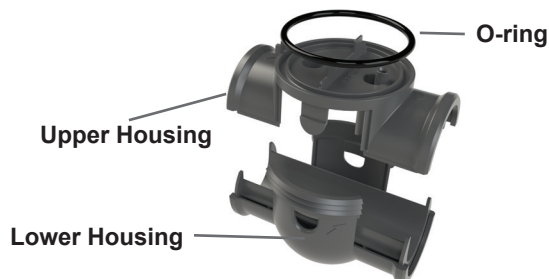
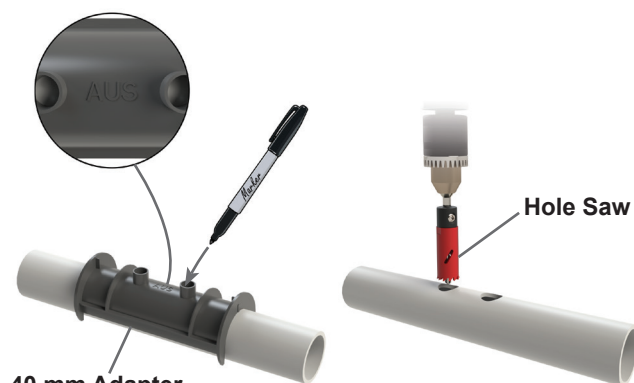

Figure 12. POD Assembly

3. Remove the 40 mm adapter from the lower POD housing.
4. Place the 50 mm guide on the top of the pipe.

NOTE: For 40 mm installations use the 40 mm adapter marked "AUS" as the guide for marking the pipe, for 50 mm installations use just the bottom of the POD assembly.

5. Mark the pipe through the holes.
6. Drill holes in the PVC pipe using the hole saw. Make sure the edges are smooth without burrs.



40 mm Adapter
Figure 13. Mark and Drill Pipe

5.3 Install the POD

1. For 40 mm pipe installations, insert the adapter into the holes in lower POD housing.



Figure 14. Assemble the POD

- Note the arrows on the upper housing indicating flow direction. Make sure the pod is in proper orientation.

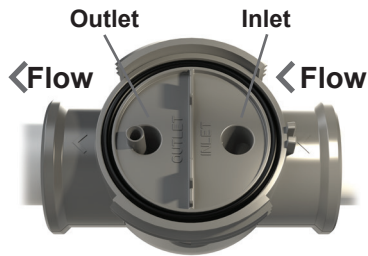

Figure 15. POD Orientation

- Assemble the POD around the pipe, the tabs will click into place.

5.4 Install the POD Cap

- Place the POD cap on the POD assembly. The cover and POD assembly are keyed for proper orientation. Use caution to ensure the POD O-ring is clean and properly seated.
- Align the arrow on the POD with the locking ring.

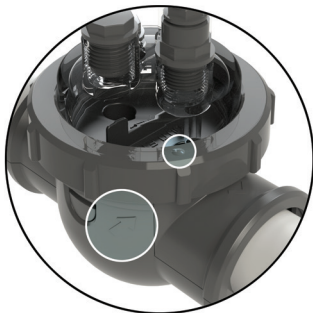

Figure 16. POD Locking Ring Orientation

- Tighten the locking ring with the locking collar tool until snug. Do not overtighten.

5.5 Install and Calibrate the Sensor(s)

- Install the sensor holder(s) into the correct port on the POD cap. Remove the cap plug if necessary.

NOTE: The ORP sensor is with Dual Link module only.

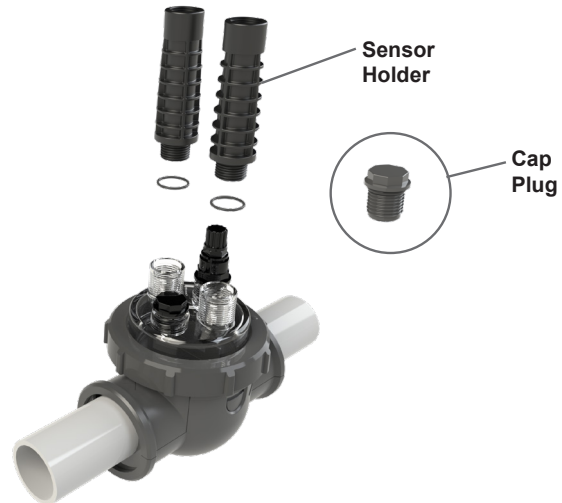

Figure 17. Sensor Holder Installation

- Carefully remove the protective tube from the sensor.
- Rinse the end of the sensor with tap water. Shake off excess water.
- Carefully screw the sensor(s) into sensor holder.



Figure 18. pH/ORP Sensor Installation

- Calibrate the sensor(s). (See Section 5.7. Calibration Procedure)

To maintain accurate and reliable operation, the sensors must be calibrated before the initial use of the controller with pH/Dual Link module. After initial calibration, it is recommended to recalibrate sensors every few months.

- Connect the sensor lead(s) to the module at the base of the controller (pH = blue), (ORP = yellow).



Figure 19. pH/ORP Connection Ports

5.6 Install the pH Down Intake and Injection lines.

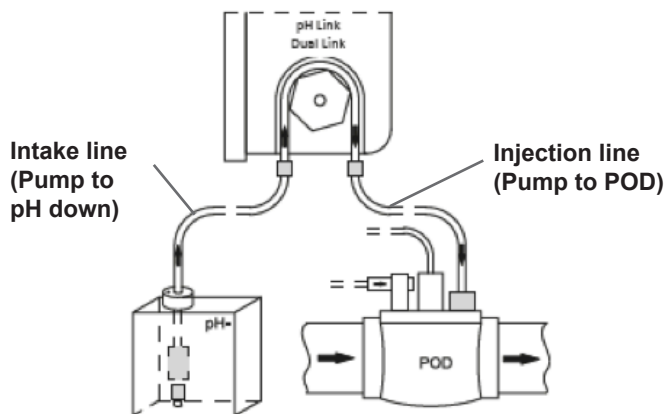

Figure 20. pH- Pump Configuration

The pump rotates in a clockwise direction. Acid is fed into the left side of the pump (via the Intake line) and injected into the POD from the right side (via the Injection line).

CAUTION: For safety reasons, install the Injection line before the Intake line to ensure pH is not accidentally dosed into the system before all connections are made.

Never store acid directly underneath any equipment as fumes will cause corrosion and resulting damage can void your warranty. It is recommended to store your acid container in a safe, protected well ventilated area.

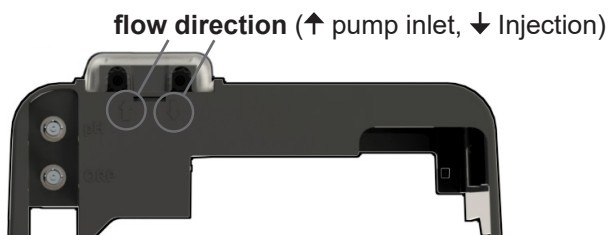

Figure 21. pH- Pump Ports

5.6.1 Install the Injection Line

1. Remove the protective cover from the pump.
2. Cut a section of the plastic tubing that has adequate length to reach from the injection valve at the pump to the non-return valve on the POD.
3. Remove the threaded cap from the pump outlet (right).
4. Thread tubing through the hole in the cap, connect the tubing to the nipple on the module and reattach the threaded cap.

NOTE: For a better fit, soften both ends of the tubing by immersing in warm water.

5. Remove the threaded cap from the POD intake valve.
6. Thread tubing through the hole in the cap, connect the tubing to the nipple on the POD and reattach the threaded cap.

5.6.2 Install the pH Down Intake Line

1. Cut a section of the plastic tubing that has adequate length to reach from the pH down reservoir to the pump.
2. Remove the threaded cap from the pump inlet (left side).
3. Pass one end of the tubing through the threaded cap and attach tubing to the nipple on the pump inlet.
4. Remove the cap from the pH down container.
5. Select the appropriate size acid cap (included), either 5 L or 15/20 L.
6. Thread tubing through the hole in the cap through the ceramic weight.
7. Remove the nut from the blue compression fitting.
8. Pass the tubing through the nut and attach it to the nipple on the compression fitting.
9. Reattach the threaded nut.
10. Put the weighted end of the hose into the pH down reservoir.
11. Secure the pH down cap tightly on the container.
12. Replace the protective cover on the pump.



Figure 22. pH- Intake Connections

5.7 Calibration Procedure

To maintain accurate and reliable operation, the sensors must be calibrated before using the controller with pH/Dual Link module. After initial calibration, it is recommended to recalibrate sensors every few months.

5.7.1 Clean the Sensor(s)

Sensor(s) must be cleaned before calibration, including prior to initial use after installation.

1. Turn off the filter pump.
2. Close all valves.
3. Remove the sensor and the sensor holder from the POD.
4. Rinse the sensor with tap water for 1 minute. Shake off excess water.

NOTE: To avoid damaging the active sensor, do not rub or dry with a cloth.

5. Brush the junctions and metal strip using a toothbrush for 1 minute.



Figure 23. Cleaning Probe

6. Prepare a diluted hydrochloric acid solution by pouring 50 mL tap water into 1 mL (10 drops) of commercially-available hydrochloric acid (HCl 37%).

⚠ WARNING

- Hydrochloric acid is a hazardous chemical that may cause burns, lesions, and irritations. Handle with extreme care using protective equipment (gloves, goggles, coveralls). Refer to the substance SDS sheet for more information.
- Always pour acid into water; do NOT pour water into acid.
- Once cleaning is complete, dispose of the solution according to the applicable code(s) or standard(s) in effect in the country of use.

7. Wash the sensor in the diluted hydrochloric acid solution for 2 minutes.
8. Rinse sensor in clean tap water for 1 minute. Shake off excess water.

5.7.2 Calibrate the pH Sensor

The pH sensor (blue) can be calibrated in 1 or 2 points. We recommend 2-point calibration for a more reliable measurement throughout the season.

1. Turn on power to the controller.
2. Turn off the pool pump and close valves as necessary to isolate the cell and sensors.
3. Unscrew the pH sensor from the POD.
4. Rinse the end of the sensor with tap water. Shake off excess water. Do not touch the glass bulb at the end of the pH sensor.
5. Start 1 or 2 point calibration via the controller User Interface, see Section 8.3 For details.
6. If calibration is unsuccessful, see Section 11. Troubleshooting.

5.7.3 Calibrate the ORP Sensor

1. Verify power to the controller is on, pump is off, and valves are closed isolating the cell and sensors.
2. Unscrew the ORP sensor from the POD.
3. Rinse the end of the sensor with tap water. Shake off excess water. Do not touch the end of the ORP sensor.
4. Place the probe in a sample of ORP 470 mV buffer solution for one minute.
5. Start calibration via the controller User Interface, see section 8.4.
6. Once calibration is complete, replace the sensor on the POD. If calibration is unsuccessful, see Section 11.

Section 6. Prepare and Balance the Pool

6.1 pH Regulation Principle

The amount of chlorine needing to be produced is dictated by the pH level in the pool. As the pH level rises, the amount of chlorine must be increased to compensate, see Table 6.

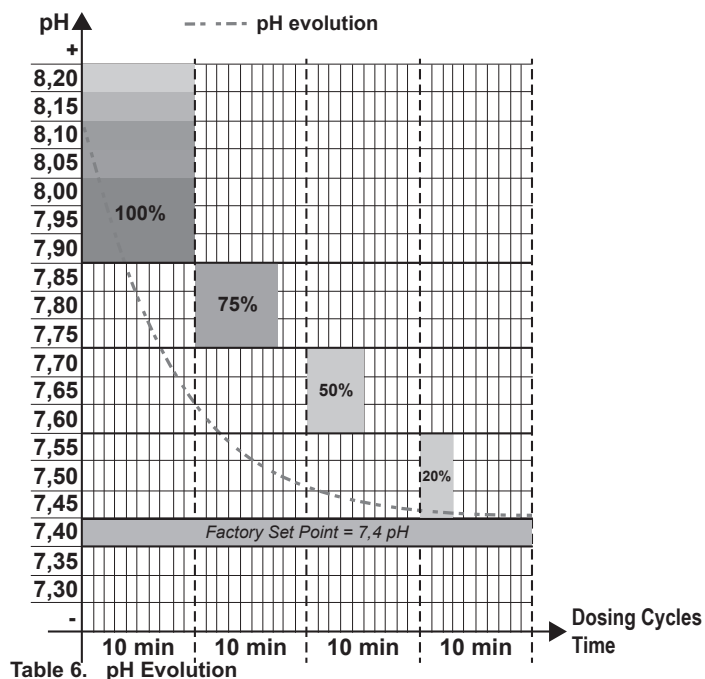

Table 6. pH Evolution

6.2 Water Chemistry Table

Test and maintain correct water balance throughout the season, according to the table.

	Free Chlorine	pH	Total Alkalinity (ppm)	Calcium Hardness (ppm)	Cyanuric Acid (ppm)	Salt Level (ppm)	Metal
Australian Standard	1 - 3	7.2 - 7.8	60 - 200	100 - 400 ***	up to 50	4000 - 7000	x
Ideal range	1 - 3	7.4	80 - 140	90 - 300	up to 50	4000 at 27°C	< 0.10 ppm
To Increase	Add chlorine or increase equipment output	Add buffer or soda ash (sodium carbonate)	Add sodium bicarbonate	Add calcium chloride	Add cyanuric acid	Add salt or minerals **	x
To Decrease		Add muriatic acid	Add muriatic acid or dry acid	Partially drain and refill pool*	Partially drain and refill pool*	Partially drain and refill pool*	x
In Season Testing Frequency	Weekly	Weekly	Weekly	Weekly	Weekly	Monthly	x

NOTE: Test all equipment sensors quarterly.

* Fill pool with water from the mains water supply. Do not use rain water or well water.

** Do not add salt directly into the skimmer. Do not initiate electrolysis until salt has fully dissolved.

*** Reading is True Calcium Hardness, not Total Hardness.

Table 7. Water Chemistry

6.3 Stabilizer (Cyanuric Acid)

A pool has a stabilizer content of 30 ppm and a pH of 7.4:

1 ppm free chlorine = 700 mV

➔ Therefore, the user can set their chlorination requirement to 700 mV to maintain a level of 1 ppm in the pool

If the level of stabilizer increases to 90 ppm, the ORP reading will be false:

1 ppm free chlorine = 500 mV

➔ If the user keeps his setpoint at 700 mV, he will end up chlorinating up to 5 ppm!

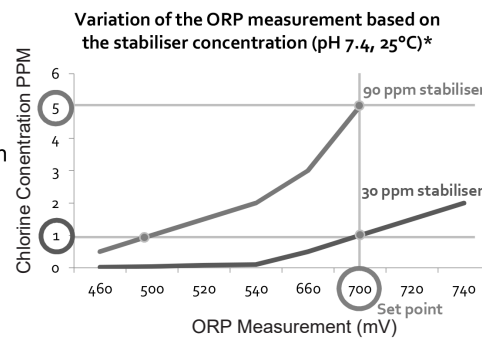

*Theoretical values to explain the principle. Actual values may vary slightly depending on various pool waters

IT IS THEREFORE ESSENTIAL TO MONITOR THE STABILIZER LEVEL IF AN ORP REGULATOR IS INSTALLED

30 PPM IS THE RECOMMENDED LEVEL FOR SWIMMING POOLS IN AREAS WITH STRONG SUNLIGHT

THIS IS UNNECESSARY IN OTHER CASES, ESPECIALLY IF ORP REGULATION IS USED

Section 7. Operation

7.1 User Interface Overview

⚠ CAUTION

To avoid to avoid risk of serious damage to the equipment and/or electrocution which could result in serious injury or death, ensure that all salt added to the pool has completely dissolved before activating the chlorination function of your system.

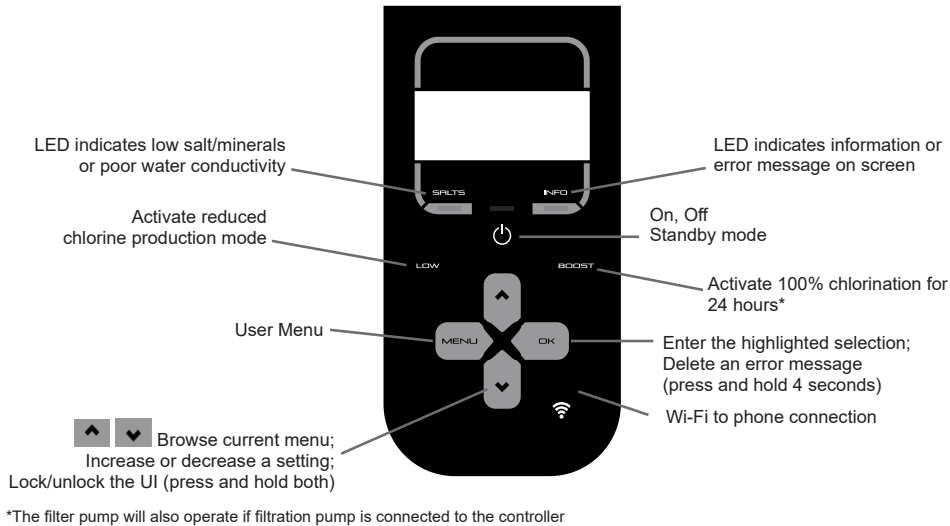

Figure 24. Controller User Interface

7.2 Initial start-Up

The following setting must be configured at the initial start up of the device. Settings can be changed or updated at a later time using the general menu, details can be found in Section 8.

From factory, the chlorination is set at 50 %. It can be set between 0 and 100 % in 10 % increments from the “main screen” by pressing ▲▼. The set value is valid until the next modification.

7.2.1 System Power

1. Press to enter Standby mode.
2. Press again to start chlorination and filtration.
3. Press and hold for 3 seconds to turn the controller off.

7.2.2 Language

1. Press .
2. Use ▲▼ to select “Language” then press .
3. Use ▲▼ to browse language the options.
4. Press to make a selection.



7.2.3 Set Clock

1. Press .
 2. Use ▲▼ to select “Programming” then press .
 3. Use ▲▼ to select “Clock” then press .
 4. Use ▲▼ to set hour then press .
 5. Use ▲▼ to set minutes then press .
- NOTE: Press and hold ▲ or ▼ to increment time by 10.
6. Press to exit.

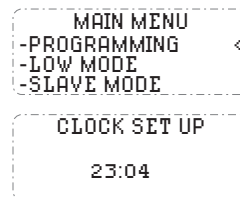

7.2.4 Boost Mode

In some cases, the pool may require a higher than normal chlorination level such as in cases of high use, poor weather or at the start of the season. Boost mode is used to increase the chlorine level quickly.

Boost mode lasts for 24 cumulative hours at 100% production output. If the program is set to perform chlorination 12 hours per day, Boost mode will be active for 12 hours on the first day and 12 hours on the second day. If the filter pump is connected to the controller, the filter pump will operate in Boost mode also. The controllers operating times including filtration schedules are temporarily

ignored for the duration of the Boost mode. Once Boost mode completes, the controller and filter pump will resume programmed operations.

NOTE: If the device is equipped with a Dual Link module, the Boost mode will not take the ORP value into account. The Boost mode takes priority over the ORP regulation

1. Press **BOOST**.

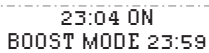

23:04 ON
BOOST MODE 23:59

2. If the controller is in Low/Cover mode you will need to confirm that you want Boost mode to override Cover or Low mode settings.

7.2.5 Low Mode

Low mode is designed to reduce chlorine production in situations where the pool is covered or when pool use is limited. Chlorine production needs will be lower when pool use is low and/or when pool water is not exposed to UV rays etc.

Low mode output can be set in the main menu settings for Low mode. Low can be set from 0%-30% in 10% increments. Programs are still active while the controller is in Low/Cover mode.

1. To manually enter Low mode press **LOW**.
2. To exit Low mode press **LOW** again.

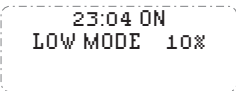

23:04 ON
LOW MODE 10%

7.2.6 Cover Mode

If the pool is equipped with a compatible electric roller cover, this can be connected to the controller in order to automatically reduce chlorination upon closing the cover, this is known as Cover mode, see Table 5 and Figure 10 for wiring details. Chlorination will resume at the level determined by the programming upon opening the compatible electric cover.

Cover mode output can be set in the main menu settings for Low mode. Low can be set from 0%-30% in 10% increments. Programs are still active while the controller is in Low/Cover mode.

Check that the cover is compatible and connected to the chlorinator.

Cover mode will automatically be activated when the cover is closed. The Cover mode message and the output percentage are displayed on the screen.

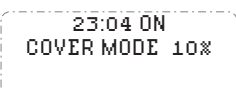

23:04 ON
COVER MODE 10%

Cover mode will stop as soon as the cover is completely open.

If the controller is equipped with a Dual Link module we do not recommend connecting the Cover mode. More specifically, chlorination is managed via the Dual Link module. In cases where the Cover mode is connected in the presence of a Dual Link module: chlorination will take place upon closing the roller cover, even if the ORP measurement is greater than the setpoint value.

7.2.7 Cold Water Protection

In addition to recording and displaying the water temperature, the temperature sensor is used to protect the cell, which is sensitive to cold water.

The temperature displayed on the top left of the home screen will begin to flash at 15°C.

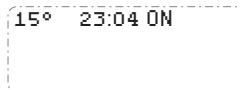

15° 23:04 ON

When water temperature is under or equal to 15°C, chlorine production automatically switches to the level defined in Low/Cover mode.

When water temperature is under or equal to 10°C, chlorine production is stopped. The absence of chlorination at this temperature is not hazardous, as bacterial development is slowed in cold water.

In addition to the flashing temperature, a “LOW TEMPERATURE” message is alternately displayed.

Even in cold water temperatures, Boost Mode may be initiated.

When the temperature goes over 10°C again, the output percentage will be set to Low/Cover.

When the temperature goes over 15°C again, chlorination resumes its level of operation configured using programs.

7.2.8 Locking the Controller

The controller can be locked, thus deactivating the buttons on the user interface panel. Simultaneously press and hold the **▲** and **▼** buttons for 3 seconds. This function can be accessed from any screen/menu.

Locking the controller automatically returns the user to the home screen. To unlock the controller, press and hold the **▲** and **▼** buttons for another 3 seconds.

Section 8. Installing and Assigning Equipment

8.1 Filter Pump

Both single and variable speed pumps can be connected to and operated by the controller.

8.1.1 Single Speed Filter Pump

NOTE: For any manually-operated variable speed pump (i.e., any pump that does not have an RS485 communication cable), you must set the pump configuration to single speed.

1. Disconnect power from the chlorinator and remove the cover and lower housing.
2. Connect the filter pump to the controller at the pump connection point in the high voltage raceway. For Australian installations plug the filter pump into the socket provided on the underside of the control unit see Table 5 and Figure 10 for wiring details.
3. Replace the lower housing and cover.
4. Plug the pump into the socket in the base of the chlorinator.

8.1.2 Assign Single Speed Pump

1. Press **MENU**.
2. Use **▲▼** to select "Filter Pump" then press **OK**.
3. Use **▲▼** to select "Single Speed" then press **OK**.
4. The user interface will prompt "Single Speed Plug to Device". Use **▲▼** to select "Yes" then press **OK**.

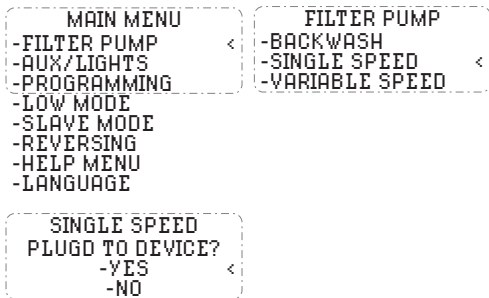

8.1.3 Variable Speed Filter Pump

The following pump models are compatible:
FloPro™ VS, Flopro™ VS AUT

NOTE: Not compatible with Zodiac e3 1Hp pump, or any other manually-operated variable speed pump that does not have an RS485 communication cable; is compatible with e3 1.5Hp pump, which features RS485 compatibility.

1. Disconnect power from the chlorinator and remove the cover and lower housing.

2. Connect the filter pump to the controller at the VSP RS485 connection point in the low voltage raceway, see Table 5 and Figure 10 for wiring details.
3. Remove the single screw on the rear hatch of the VS pump to access the red 4-pin connector and communication cable. If the On Board Controller is connected to the RS485, remove it and set it next to the hatch.

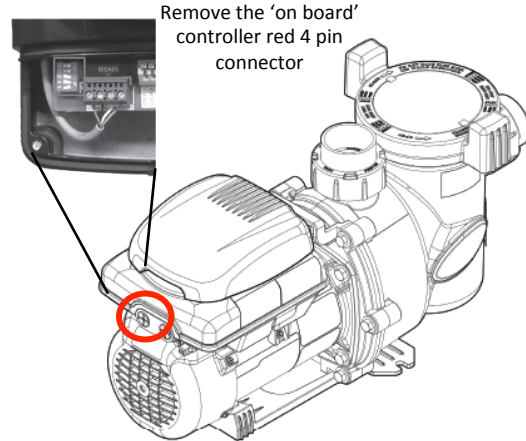

4. Feed the cable with red pin connector through the cable gland hole and push onto the four pins on the pump PCB.
5. Run the cable from the VS pump through the soft membrane under the chlorinator housing (pierce with a screwdriver).

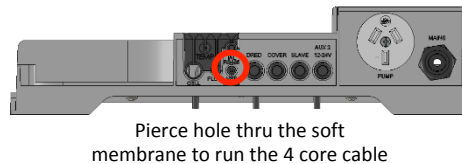

6. Strip a few cm of bare wire from the 4 core cable and connect the cable to the low voltage section marked 'VSP RS485'.
7. Ensure the RS485 wires are in the proper order.
8. Ensure the pump DIP switches are in the correct position as follows:
1 = up
2 = up
3 = down
4 = down
5 = up

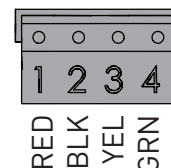
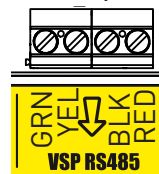

On the Controller

On the Pump

NOTE: Do not change the position of the dip switches on the pump.

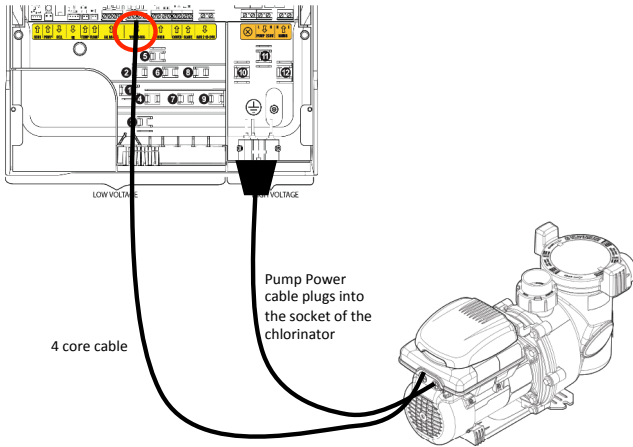

9. Replace the lower housing and cover.
10. Plug the pump into the socket in the base of the chlorinator.

8.1.4 Assign Variable Speed Pump

1. Press **MENU**.
2. Use **▲▼** to select "Filter Pump" then press **OK**.
3. Use **▲▼** to select "Variable Speed" then press **OK**.
4. The user interface will prompt "Variable Speed Plgd to Device". Use **▲▼** to select "Yes" then press **OK**.
5. Use **▲▼** to select a speed then press **OK**.
6. Use **▲▼** to adjust the RPM.
7. Once desired RPM is reached, press **OK**.
8. Press **MENU** to exit.

NOTE: If multiple VSP timers have a time slot in common, the higher RPM will be operated.

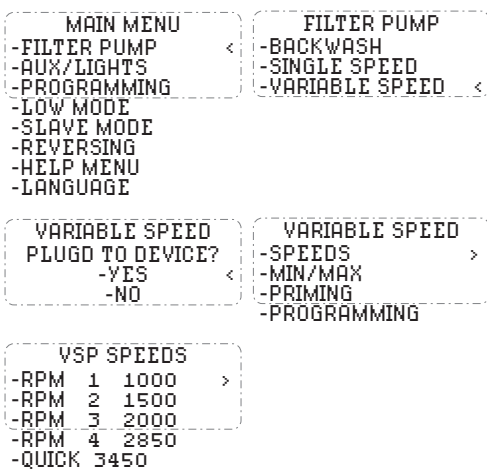

8.1.5 Quick Clean

Quick Clean is a backwash mode is used to quickly start/stop the filter pump (single- or variable-speed pump) in order to backwash the filter.

For variable speed pumps, the backwash RPM is set under "Quick".

1. Select YES to activate filtration.
2. Select NO to stop filtration.

For safety reasons, the chlorination is stopped during the backwash mode. To avoid emptying the pool, the backwash mode automatically stops after 5 minutes. The variable speed pump RPM is by default set at 3450 rpm (max speed). This can be changed in the priming menu.

8.2 Aux/Lights

The chlorinator is capable of controlling devices in addition to the filter pump. The equipment must be connected to the chlorinator using the appropriate auxiliary line:

Aux 1: for equipment connected to the high voltage supply (230 V) (not applicable for Australia).

Aux 2: for equipment connected to the low voltage supply (12/24 V).

The following functions are available in the AUX/LIGHTS menu for auxiliaries 1 and 2:

- Turn the lights or aux equipment on/off
- Program a timer (See section 8.7.6 for details)

NOTE: For Australian chlorinator to control the light transformer, an additional switching box is required. Please contact your local pool care professional for this relay box, item code WW000222.

1. Remove the lower housing and cover to expose the connection bar.
2. Run the supplied low voltage 2 core wire through the rubber grommet from the relay switch box into the terminal bar marked 'AUX 2'.
3. Push the red pin connector into the relay switch.
4. Use cable ties to hold in place if necessary, then replace the cover/s.
5. Plug the relay switch box into any available 240V GPO.
6. Plug the light transformer directly into the socket located in the switch box. This will now control the light directly from the chlorinator.

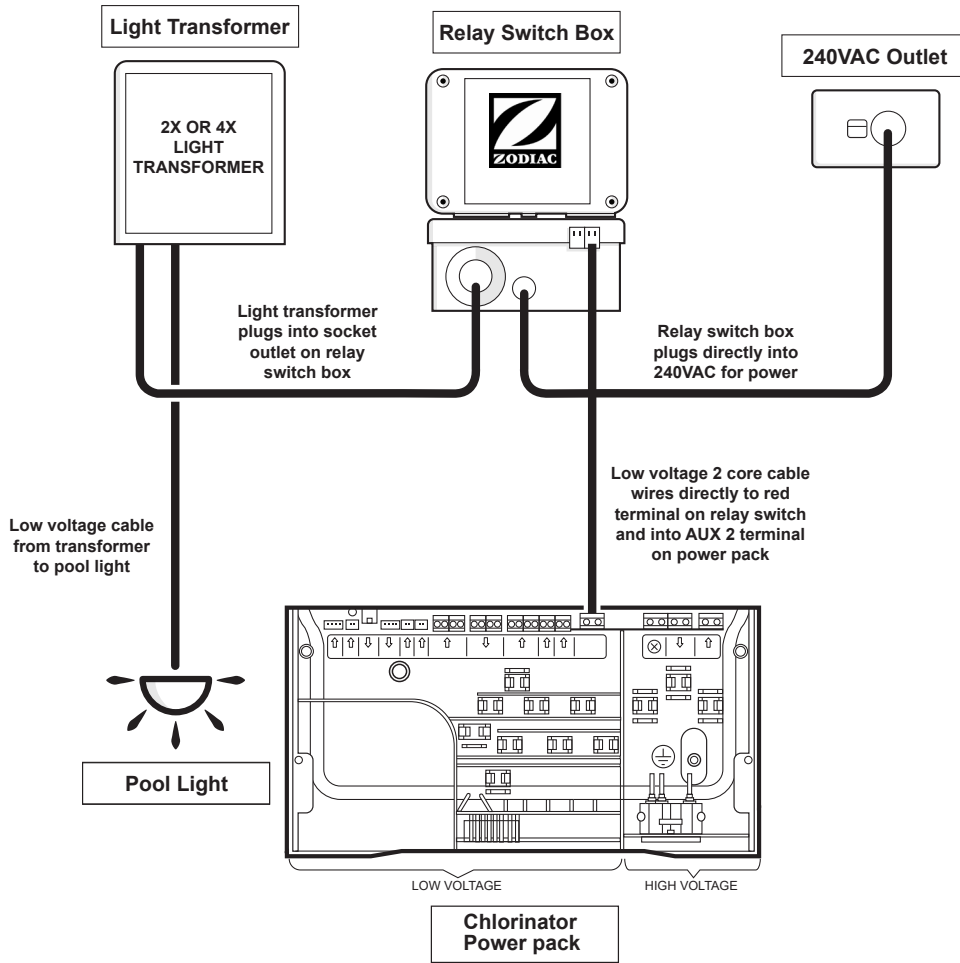
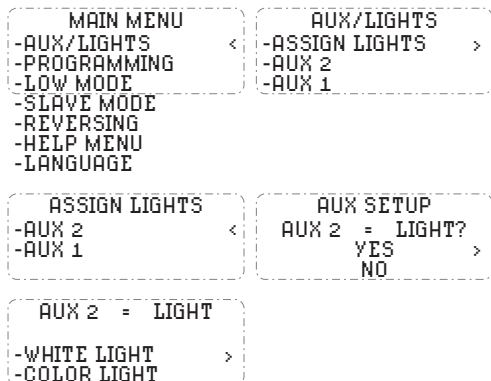

Figure 25. Light Transformer, Switch Box and Chlorinator Connections

8.2.1 Assign Lights

1. Press **MENU**.
2. Use **▲▼** to select "Aux/Light" then press **OK**.
3. Use **▲▼** to select "Assign Lights" then press **OK**.
4. Use **▲▼** to select "Aux 2" then press **OK**.
5. Use **▲▼** to select "Yes" then press **OK**.
6. Use **▲▼** to select "White Light" or "Color Light" then press **OK**.
7. Press **MENU** to exit.



8.2.2 White Light Operation

1. Press **MENU**.
2. Use **▲▼** to select "Aux/Light" then press **OK**.
3. Use **▲▼** to select "Aux 2/Light" then press **OK**.
4. Use **▲▼** to select "On", "Off", or "Set Timers", then press **OK**.
5. Press **MENU** to exit.

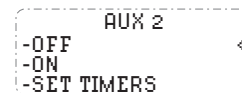

8.2.3 Color Light Operation

1. Press **MENU**.
2. Use **▲▼** to select "Aux/Light" then press **OK**.
3. Use **▲▼** to select "Aux 2/Light" then press **OK**.
4. Use **▲▼** to select desired color, "Off", "On" or "Define Color", then press **OK**.

- If “Define Color” selected, use ▲▼ to select desired color then press **OK**.
- Press **MENU** to exit.

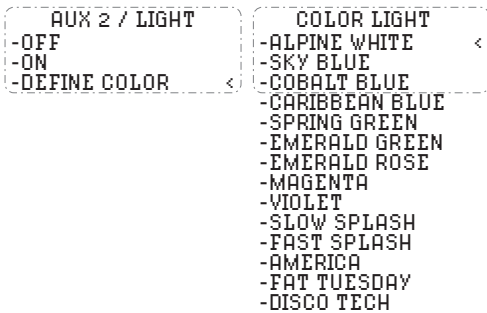

Note: Colour sequence is relevant for Zodiac colour lights only. If other manufacturers lights are installed the colour selection will vary

8.3 Heating

The chlorinator is compatible with all types of pool heating: heat pump, heat exchanger, electric heater. The built-in water temperature sensor manages set point temperatures to start heating only when needed.

The heating system must be wired to the chlorinator exclusively using the Aux 2 connector.

8.3.1 Heating System with On/Off Remote Control Connector

For heating systems fitted with a specific contact for remote On/Off command:

- Connect a 2 x 0.75 mm² electric wire (not supplied) of the appropriate length to the green Aux 2 connector on the chlorinator.
- Connect the chlorinator contact to the wire.
- Follow the connection and activation procedure for the On/Off function in the heating system manual.
- Set the heating system setpoint temperature to the **maximum** setting. The chlorinator will manage the water heating via its own water temperature sensor.

8.3.2 Heating System without On/Off Remote Control Connector

For all heating systems not equipped with a remote On/Off contact, serially connect to the flow switch (present on all heating systems).

- Connect a 2 x 0.75 mm² electric wire (not supplied) of the appropriate length to the green Aux 2 connector on the chlorinator.

- Disconnect one of the two flow switch wires from the terminal block of the heating system. (Refer to the heater manual, if necessary.)
- Connect one wire from Aux 2 to the terminal block in place of the disconnected wire.
- Connect the disconnected heating system wire to the wire on the Aux 2 terminal block of the chlorinator using a connecting terminal.
- Set the heating system setpoint temperature to the **maximum** setting. The chlorinator will manage the water heating via its own water temperature sensor.

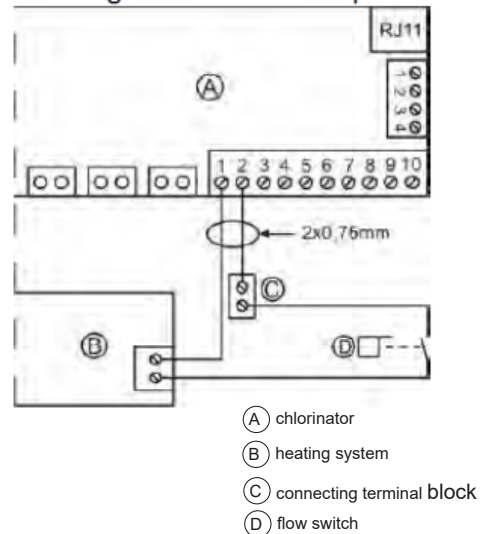

8.3.3 Assign Heating System

- Press **MENU**.
- Use ▲▼ to select “Auxiliaries” then press **OK**.
- Use ▲▼ to select “Assign Heating” then press **OK**.
- Use ▲▼ to select “Aux 2” then press **OK**.

NOTE: Once a heating system has been assigned, it is not possible to set another Aux 2 timer, such as for lighting.

- Use ▲▼ to select “Yes” then press **OK**.
- Press **MENU** to exit.

The heating system is activated when the filtration pump is running and the water temperature is below the setpoint.

After assigning a heating system, a new sub-menu appears in the Main Menu as ‘HEATING’.

Under the HEATING menu, available settings are:

- DISABLE - heating system set to off
- ENABLE - heating system set to on
- SETPPOINT - set water temperature setpoint in 1°C increments (min 15°C/ max 35 °C)
- HEATING PRIORITY - activate heating priority. If you have a variable speed pump connected, select speed setting for heating priority mode

8.3.4 Heating Priority

When a filtration pump (single speed or variable speed) is assigned and the heating priority function is activated outside of the filtration timers, the filtration pump will turn on for 5 minutes every 120 minutes in order to check water temperature.

NOTE: If a Zodiac®-compatible variable speed pump is used, you can assign one of the filtration speeds to the heating priority feature.

If the water temperature is lower than the setpoint by -1°C, the heating system is activated and the filtration pump stays on until the water temperature reaches the desired setpoint.

If the water temperature is higher than the setpoint by +1°C, the heating system is not activated and the filtration pump turns off until the next cycle.

Section 9. Calibration and Priming

9.1 pH Sensor Calibration

The pH sensor may be calibrated in 1 point calibration or 2 point calibration (pH 4 and pH 7); 2 point calibration is recommended.

1. Turn on power to the controller.
2. Turn off the pool pump and close valves as necessary to isolate the cell and sensors.
3. Press **MENU**.
4. Use **▲▼** to select “pH Setup” then press **OK**.
5. Use **▲▼** to select “pH Calibration” then press **OK**.
6. Use **▲▼** to select “1 Point”, or “2 Points”, then press **OK**.
7. Remove the pH sensor from the POD.
8. Insert the pH sensor into the pH 7 buffer solution.
9. Press **OK** while “Start” is selected.
10. Press **OK** while “Go to Step 2” is selected.
11. Rinse the pH sensor with tap water.
12. Insert the pH sensor into the pH 4 buffer solution.
13. Press **OK** while “Start” is selected.
14. Press **OK** while “Continue” is selected.
15. Press **MENU** to exit.

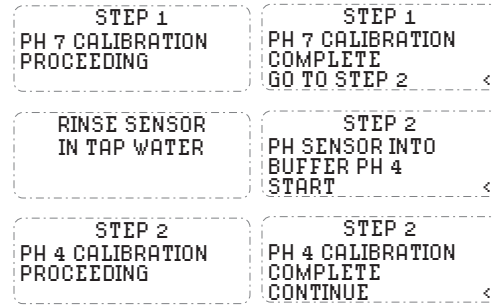
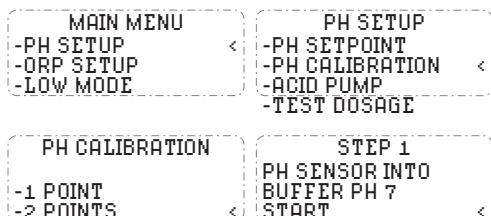

9.2 ORP Sensor Calibration

1. Turn on power to the controller.
2. Turn off the pool pump and close valves as necessary to isolate the cell and sensors.
3. Press **MENU**.
4. Use **▲▼** to select “ORP Setup” then press **OK**.
5. Use **▲▼** to select “ORP Calibration” then press **OK**.
6. Remove the ORP sensor from the POD.
7. Insert the ORP sensor into the 470 mV buffer solution.
8. Press **OK** while “Start” is selected.
9. Press **MENU** to exit.

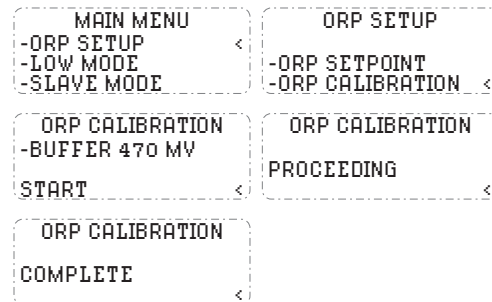

9.3 Setpoint(s)

Current setpoints are displayed on the Home screen whenever the controller is ON.

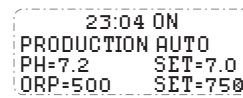

9.3.1 Establish the pH Setpoint

Establishing the pH setpoint determines when acid will be added to the system to decrease the pH of the water.

1. Press **MENU**.
2. Use **▲▼** to select “pH Setpoint” then press **OK**.
3. Use **▲▼** to select value then press **OK**.
4. Press **MENU** to exit.

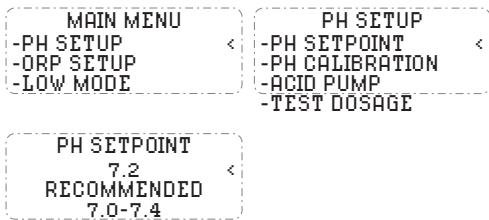

- Default pH setting is 7.2.
- Use **▲▼** to change the setpoint by increments of 0.1.
- pH setpoint range is from 6.8 (min) to 7.6 (max).

9.3.2 Establish the ORP Setpoint

Establishing the ORP setpoint determines when chlorine should be produced by the system to chlorinate the water. Free chlorine level should be checked every few days after initial installation.

1. Press **MENU**.
2. Use **▲▼** to select “ORP Setup” then press **OK**.
3. Use **▲▼** to select “ORP Setpoint” then press **OK**.
4. Use **▲▼** to select value then press **OK**.
5. Press **MENU** to exit.

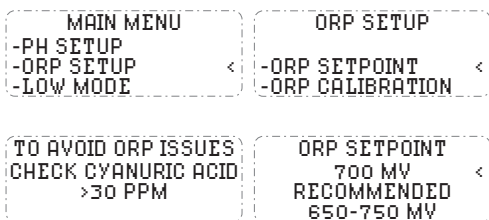

- Default ORP setting is 700 mV.
- Acceptable range = 600 mV (min.) - 900 mV (max)

9.4 Prime and Test the pH Dosing Pump

The dosing pump is deactivated during the first 8 hours of the device in order to prevent acid exposure during installation. The pH dosing pump can be directly activated directly in order to perform a five-minute operating test.

⚠ WARNING

- Hydrochloric acid is a hazardous chemical that may cause burns, lesions, and irritations. Handle with extreme care using protective equipment (gloves, goggles, coveralls). Refer to the substance SDS sheet for more information.
- Always pour acid into water; do NOT pour water into acid..
- Dispose of the solution according to the applicable code(s) or standard(s) in effect in the country of use.

1. Press **MENU**.
2. Use **▲▼** to select “pH Setup” then press **OK**.
3. Use **▲▼** to select “Test Dosage” then press **OK**.
The acid pump will perform a five-minute operating test.
4. Press **OK** while “Start Test” is selected to begin.
5. Press **OK** while “Stop Test” is selected to cancel.
6. Press **MENU** to exit.

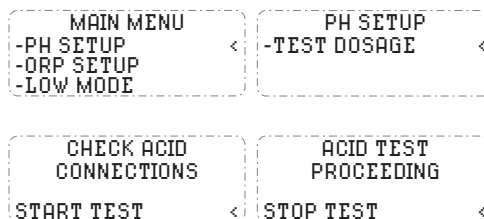

- Pump stops automatically upon completion of the five-minute test.

9.4.1 Pause Acid for Pool Service

During regular maintenance, it may be required to add ‘Alkalinity Up’ (often called buffer). This will cause a pH sensor to fluctuate its readings. It is advised to pause acid delivery for 8 hours whenever ‘Alkalinity Up’ is added to the pool to prevent the dosing of acid at the same time.

1. Press **MENU**.
2. Use **▲▼** to select “Acid Pump” then press **OK**.
3. Use **▲▼** to select “Stop” then press **OK**.
4. Use **▲▼** to select “Yes” Stop Injection for 8 Hours, then press **OK**.
5. Press **MENU** to exit.



- Acid delivery begins automatically at the end of 8-hour period.

9.5 Programming/Timers

The controller has two internal operating timers. The timers are used to define the length of time for the filter pump to operate, and the length of time for the Salt Water Chlorinator (SWC) to produce chlorine. This offers the user the advantage of running their variable speed pump longer at lower flow rates, without having the chlorinator producing the whole time.

In order to complete the timer program, it is necessary to enter and validate both ON and OFF times. If no timer is set, the filtration and / or chlorination will run continuously

The filtration operating times must be sufficient to correctly treat the water.

Example - single speed pump:

In Season filtration time: 8-10 hours per day.

Off Season filtration time: 4-5 hours per day.

Example - variable speed pump (when running at lower speeds):

In Season filtration time: 12-14 hours per day

In Season SWC time: 8-10 hours per day

Off Season filtration time: 10-12 hours per day

Off Season SWC time: 4-5 hours per day

Once validated, The SWC will adopt the same timers as the filtration pump. The chlorination time must be equal or shorter than the filtration time. The device will not accept a SWC timer longer than or outside the programmed filtration time.

9.5.1 Reset Timers

1. Press **MENU**.
2. Use **▲▼** to select "Programming" then press **OK**.
3. Use **▲▼** to select "Reset Timers" then press **OK**.

The selected timers will be reset to 00:00.

9.5.2 Operation With an External Timer

In order for the controller to operate with an external timer. All controller programs must be cleared and the device must be on. After the connection to the external timer is made, turn the controller off then back on again.

9.5.3 Single Speed Programming

1. Press **MENU**.
2. Use **▲▼** to select "Programming" then press **OK**.
3. Use **▲▼** to select "Filter Pump" then press **OK**.
4. Use **▲▼** to select "Pump Timer 1" or "Pump Timer 2" then press **OK**.
5. Use **▲▼** to select the hour for the filtration on time then press **OK**.
6. Use **▲▼** to select the minutes for the filtration on time then press **OK**.
7. Use **▲▼** to select the hour for the filtration off

time then press **OK**.

8. Use **▲▼** to select the minutes for the filtration off time then press **OK**.
9. Press **MENU** to exit.

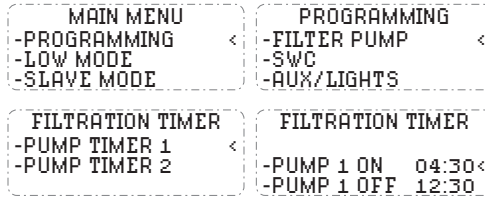

10. When a filtration program has been confirmed the letter "P" is displayed on the top right of the screen.

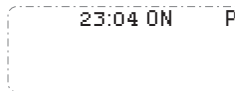

Manual activation of the device (pressing **⏻**) takes priority over the timer. If no filter pump is connected, the controller will only start chlorination. If a single speed filter pump has been connected the filter pump will start along with chlorination. If a variable speed pump filter pump has been connected the filtration pump will run along with the chlorination at it's set RPM 1 speed. All programs will still be valid and will resume normal operation the next cycle.

9.5.4 Variable Speed Programming

1. Press **MENU**.
2. Use **▲▼** to select "Programming" then press **OK**.
3. Use **▲▼** to select "Filter Pump" then press **OK**.
4. Use **▲▼** to select "Timer Speed (1-4)" then press **OK**.
5. Use **▲▼** to select the hour for the filtration on time then press **OK**.
6. Use **▲▼** to select the minutes for the filtration on time then press **OK**.
7. Use **▲▼** to select the hour for the filtration off time then press **OK**.
8. Use **▲▼** to select the minutes for the filtration off time then press **OK**.
9. Press **MENU** to exit

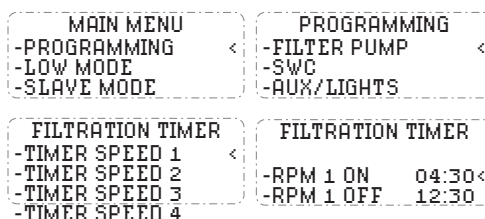

- When a filtration program has been confirmed the letter “P” is displayed on the top right of the screen.

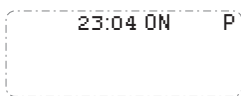

Variable speed filtration timers 1 and 2 are linked to the SWC programs. Once validated, these programmed times are also set as SWC timers 1 and 2.

9.5.5 Salt Water Chlorinator (SWC) Programming

If a filtration program has been set, the chlorination program will be identical to the filtration program(s) by default. They can be changed, however the chlorination program(s) cannot be activated outside of the filtration Program(s) for safety reasons.

- Press **MENU**.
- Use **▲▼** to select “Programming” then press **OK**.
- Use **▲▼** to select “SWC” then press **OK**.
- Use **▲▼** to select “SWC Timer 1” or “SWC Timer 2” then press **OK**.
- Use **▲▼** to select the hour for the SWC on time then press **OK**.
- Use **▲▼** to select the minutes for the SWC on time then press **OK**.
- Use **▲▼** to select the hour for the SWC off time then press **OK**.
- Use **▲▼** to select the minutes for the SWC off time then press **OK**.
- Press **MENU** to exit.

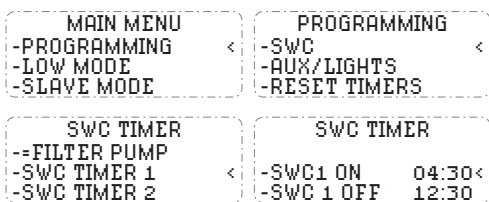

The “T” symbol is displayed in the upper right hand corner of the LCD display on the home screen if the programming is valid.

The “P” symbol is displayed in the upper right-hand corner of the LCD display on the home screen if a valid filter pump and chlorinator program has been set.

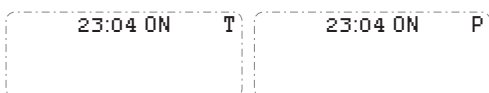

9.5.6 AUX/Lights Programming

- Press **MENU**.
- Use **▲▼** to select “Programming” then press **OK**.
- Use **▲▼** to select “AUX/Lights” then press **OK**.
- Use **▲▼** to select “AUX 1 Timer” or “AUX 2 Timer” then press **OK**.
- Use **▲▼** to select the hour for the AUX on time then press **OK**.
- Use **▲▼** to select the minutes for the AUX on time then press **OK**.
- Use **▲▼** to select the hour for the AUX off time then press **OK**.
- Use **▲▼** to select the minutes for the AUX off time then press **OK**.
- Press **MENU** to exit.

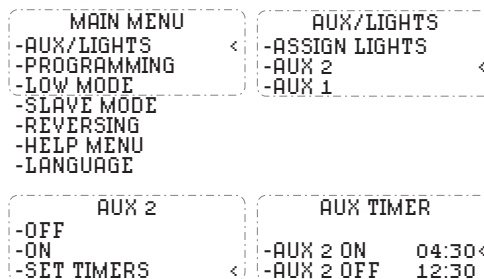

9.6 Reversing

IMPORTANT

Adjusting your cell reversal times will result in voiding of warranty. You must consult with Zodiac on 1300 763 021 or your local pool care professional before making any adjustments.

The chlorinator uses a smart polarity reversal system. Periodic polarity reversal will prevent scaling of the cell plates. The time between each reversal is factory set at 5 hours. This setting is optimal for most water conditions. However, Depending on the calcium hardness of the water, you may need to adjust the reversal time. More calcium in the water will require less time between reversals. Water with less calcium can be given more time between reversals. Shorter reversal times will cause more wear of your cell plates. The polarity reversal interval can be adjusted from 2 to 8 hours in 1-hour steps.

- Press **MENU**.
- Use **▲▼** to select “Reversing” then press **OK**.
- Use **▲▼** to select set hours then press **OK**.
- Press **MENU** to exit.



During reversal, chlorination is stopped for a few minutes. No message is displayed on the screen. Normal operation will resume after the reversal.

9.7 Slave Mode

Slave mode is applicable when the chlorinator is connected to a control device that uses a chlorine/sanitiser sensor (such as an ORP sensor). When in slave mode the chlorinator passes control of turning chlorine production on/off to the third party controller.

NOTE: Slave mode is not used when connected to a general pool automation controller such as AquaLink. It only applies to an external controller that commands sanitiser output.

To enable this function, the third party controller must be connected to the “slave” connection point in the low voltage raceway see Table 5 and Figure 10 for wiring detail.

Boost and Low modes will remain operational from the controller. However, SWC programs will be deactivated. Chlorination output will be maintained at 100%.

1. Connect the external controller at the slave connection point in the low voltage raceway see Table 5 and Figure 10 for wiring details.
2. Press **MENU**.
3. Use **▲▼** to select “Slave Mode” then press **OK**.
4. Use **▲▼** to select “YES” or “NO” then press **OK**.
5. Press **MENU** to exit.

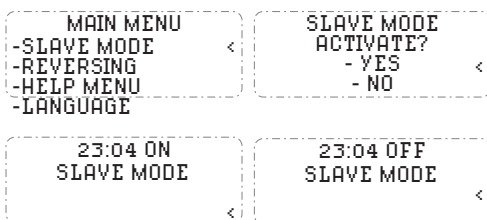

Slave mode only controls the chlorination. Filtration pump, AUX, lights and other functions are still valid.

Pressing **⏻** will take priority over Slave mode.

If a Dual Link module is installed, the ORP function is overridden by the slave mode. The pH regulation is still valid.

LOW / COVER / BOOST modes takes priority over Slave mode

Section 10. Pairing and Connecting to Wi-Fi

Always check the strength of your Wi-Fi signal before pairing. There are numerous apps available for checking Wi-Fi signal strength. If necessary, Wi-Fi signal strength can be enhanced by using range extenders such as:

- Wi-Fi Repeater - unit detects the source Wi-Fi signal and rebroadcasts it further away
- PLC Wi-Fi Hotspot - unit connects to the modem via a Powerline Communication (PLC) adapter and generates a local Wi-Fi network (“hotspot”) for connection

1. Verify Wi-Fi signal strength.
2. Verify the chlorinator is connected to power and switched on.
3. Download the iAquaLink app from the App Store or Google Play.
4. Select the chlorinator from app’s drop-down menu.
5. Follow the instructions shown in the app.

10.1 Wi-Fi Direct Mode

1. Simultaneously press and hold **▲** **OK** for 10 seconds until the **📶** LED lights up.
2. Connect to the product via your smartphone’s Settings screen.
3. Select the home Wi-Fi network and enter the Wi-Fi password (WEP/WPA key).

10.2 Invitation Code

The main user can send an invitation code to another user, such as a family member, friend, lessee, service provider, etc.

This additional user (“guest”) enters the invitation code in the app to gain access to all functions for remotely controlling the chlorinator without having to perform Wi-Fi Direct pairing.

The invitation code only provides access to the chlorinator control panel for normal control functions.

The main user can remove “guest” access at any time.

10.3 Frequently Asked Wi-Fi Connection Questions (FAQs)

How do I know if the Wi-Fi signal is strong enough where I want to install the appliance?

- Numerous apps exist for checking the signal strength of a Wi-Fi signal.
- Position the smartphone using the Wi-Fi strength analyser app in the exact place in which the product will be positioned. Wi-Fi signal can vary significantly over a short distance.

How do I know if the Wi-Fi signal is strong enough where I want to install the appliance?

- The smartphone or tablet must have Apple iOS operating system or higher or Android 4.1 or higher.
- To find out the operating system version in your smartphone or tablet, go to Settings/About Phone/software information.

Can the appliances be controlled using 3G/4G/5G instead of Wi-Fi?

- Yes, once the appliance is paired with the home Wi-Fi network, it is connected to the Internet and communicates with the app regardless of whether the smartphone is connected via Wi-Fi or 3G/4G/5G.

Can the appliance be controlled using a computer?

- AquaLink is an application originally designed for use on a smartphone or tablet. There is no 'website' allowing for connection from a computer.
- If this is absolutely necessary, emulation software exists for computers which simulates a smartphone's screen on the computer and allows the app to be used for this purpose.

Pairing issues?

- Press the pairing buttons on the product again.
- If the two LEDs/LAN and WEB icons do not light up, contact Customer Service.
- If the Wi-Fi icon does not light up or flashes, contact Customer Service.

Pairing time is too long when connecting to the Home Wi-Fi Network

- The product has a maximum time of 2 minutes, 30 seconds to connect to the home Wi-Fi network, then

the connection attempt ends.

- If nothing happens, start the home Wi-Fi connection process again. Check that you have entered the right Wi-Fi password or WEP/WPA key.
- Check the strength of the home Wi-Fi signal. If the Wi-Fi signal is weak, install a Wi-Fi repeater or PLC Wi-Fi Hotspot.

Product firmware update

- When first using the iAquaLink™ app after having installed the connected product, a firmware update may be suggested. This is required in order for the app to operate correctly.
- Firmware update generally takes about 20 minutes depending on the strength of the home Wi-Fi network. The update can take a maximum of 65 minutes.
- If the update fails, the download and/or update will resume after switching the product off, then back on.

What happens if I change my Internet Service Provider (ISP)?

- When changing ISP, the modem is replaced and has a different Wi-Fi code (password/WEP/WPA key).
- The product must be paired again in order to identify the new modem and enter the new Wi-Fi code (password/WEP/WPA key).

Section 11. Help Menu

The chlorinator will automatically notify you of any problems by displaying error messages. To help with the understanding of these messages, the controller has a troubleshooting assistance menu which gives the meanings and the action to take to solve the problem.

1. Press **MENU**.
2. Use **▲ ▼** to select "Help Menu" then press **OK**.
3. Use **▲ ▼** to select the error message then press **OK**.
4. The display will automatically scroll through a certain number of suggested solutions to explain what to do. Once automatic scrolling is complete, the chlorinator automatically returns to the "Troubleshooting" menu.
5. Press **MENU** to exit.

Section 12. Inspecting and Cleaning the Electrode

In areas that experience calcium hardness the cell electrode will benefit from cleaning.

1. Switch off the filter pump and chlorine generator, close necessary valves and unplug the cell terminal cap.
2. Unscrew the retaining ring and remove the electrode. If calcium buildup is present, immerse the electrode in cell cleaning solution without immersing the terminals.
3. We recommend using Zodiac Salt Chlorinator Cell Cleaner to clean the electrode. However, you can mix your own by carefully adding one (1) part of Hydrochloric (Muriatic) acid to ten (10) parts water. Stronger solutions will shorten terminal life.
4. Allow the cleaning solution to dissolve the calcium deposits for about 10 minutes.

NOTE: Dispose of the cleaning solution at an approved Council Depot and never into storm water or sewage drains.

5. Rinse the electrode in clean water and re-fit the electrode in the cell housing.
6. Replace the cell head and plug assembly.
7. Reset valves and switches.
8. Turn pump and controller on.
9. Confirm chlorine output and settings on the power pack. Timer programs will be automatically retained.



Figure 26. Opening the Cell

Section 13. Winterizing

The chlorinator has a protective system which will limit sanitizer production during unfavorable operating conditions, such as cold water or lack of salt.

Active winterizing leaves the filter pump and chlorinator running during the winter. This is safe for temperatures above 10°C. If temperatures drop below 10°C, the chlorination cell needs to be deactivated.

Passive winterization calls for the pool to be shut down. Water levels will need to be lowered and the piping will need to be drained. The cell electrode can be left in place with isolation valves open.

13.1 Winterize the pH/ORP Sensors

It is recommended that the plastic protective caps of the pH and ORP sensors are kept to be used as storage containers. The sensors must be stored wet in either a KCl solution (3 mol/L) or tap water. It is preferred that the sensors are stored in the KCL solution if possible.

13.2 Reopening the Pool

Required actions:

1. Adjust the water level (too much or too little)
2. Check the water parameters.
3. TAC/TH/pH/Salinity/Chlorine/Stabilizing Agent/Copper/Metals.
4. Adjust the parameters to obtain a balanced, healthy pool, see Section 6.
5. Check the condition of the equipment (pump, filter, chlorinator, electrolytic cell).
6. Where necessary, check the sensors, clean if needed and re-calibrate.
7. Once the salt level has reached the required level of 4000ppm and has dissolved in the water, restart the salt chlorinator.

Section 14. Troubleshooting

When there is an error condition, a message is displayed on the screen and the “INFO” LED flashes.

To clear an error message after the condition is resolved:

- Press and hold **OK** for 4 seconds.

When an error is linked to conductivity (low conductivity) the “SALTS” LED is ON. When the error situation is corrected, the error message and LED illumination ends automatically.

Message	Possible Cause	Solution
NO FLOW CHECK PUMP ("INFO" indicator lit during the production timers)	<ul style="list-style-type: none"> ▶ Filter pump failure.. ▶ Filter and/or the skimmer(s) are dirty. ▶ By-pass valve(s) closed. 	<ul style="list-style-type: none"> ▶ Check the pump, the filter, the skimmer(s), and the by-pass valve(s). Clean them if necessary. ▶ Check the wire connections (flow switch).
CHECK OUTPUT	<ul style="list-style-type: none"> ▶ Cell power cord disconnected or not properly connected to the cell or inside the device. ▶ Cell plates worn, calcified or out of order. ▶ Internal electronic problem in the control box following an external electric incident. 	<ul style="list-style-type: none"> ▶ Switch off the chlorinator ("Power" button) and switch off the power supply to the control box, then check that all the wires are properly connected (mains power supply, cell, etc.). ▶ Replace the cell.
LOW CONDUCTIVITY ("SALTS" indicator lit)	<ul style="list-style-type: none"> ▶ For models with a temp sensor this error can be caused by low conductivity. ▶ Lack of salt < 4000 ppm due to water loss or dilution (filter backwash, water renewal, rain, leaks, etc.). ▶ Can vary depending on the temperature and age of the cell. The voltage across the cell terminals varies in time. ▶ Cell calcified, worn, or out of order. 	<ul style="list-style-type: none"> ▶ Check water temperature. ▶ Check the condition of the cell plates. ▶ Measure the salt concentration in the pool water using a salt tester or a test strip, then add salt to the pool to keep the level at 4000 ppm. If you do not know the salt level or how to test it, contact your retailer. ▶ Is the salt level is correct?
OVER HEAT ("INFO" indicator lit)	<ul style="list-style-type: none"> ▶ The temperature inside the control box is too high, chlorination is slowed (>85°C) then stopped (> 90°C) if the temperature does not fall back down in order to protect the electric circuits. 	<ul style="list-style-type: none"> ▶ If the box is installed outdoors, protect it from direct sunlight. ▶ Chlorination will automatically resume once the temperature has fallen back down. ▶ Issue at the controller.
LOW TEMPERATURE ("INFO" indicator light is lit, the temperature on the display flashes)	<ul style="list-style-type: none"> ▶ The water temperature measured by the chlorinator temperature sensor is less or equal to 10°C; production stops in order to protect the cell. 	<ul style="list-style-type: none"> ▶ Chlorination will automatically resume at the Low Mode chlorination rate between 10 and 15°C. ▶ Chlorination will automatically resume at the normal chlorination rate above 15°C.
NONE (Chlorine production not visible at the cell plates)	<ul style="list-style-type: none"> ▶ Chlorination is in a reversing period. ▶ Chlorination is set at less than 100% and is paused. 	<ul style="list-style-type: none"> ▶ Wait and observe, chlorination should resume.
X X (displayed instead of current water temperature)	<ul style="list-style-type: none"> ▶ Temperature sensor short circuited 	<ul style="list-style-type: none"> ▶ Replace the water temperature sensor.
— — (displayed instead of current water temperature)	<ul style="list-style-type: none"> ▶ Temperature sensor not connected 	<ul style="list-style-type: none"> ▶ Check and connect the water temperature sensor.
— — (displayed instead of current pH value)	<ul style="list-style-type: none"> ▶ Acid injection not activated/deactivated. 	<ul style="list-style-type: none"> ▶ Activate acid injection in the pH menu ▶ Check and connect the pH sensor.
— — (displayed instead of current ORP value)	<ul style="list-style-type: none"> ▶ ORP sensor not connected. 	<ul style="list-style-type: none"> ▶ Check and connect the ORP sensor.
Additional messages when a pH Link or Dual Link controller is installed		
pH LOW ("INFO" indicator lit)	<ul style="list-style-type: none"> ▶ The pH level is less than 5. ▶ The pH sensor is disconnected, dirty, uncalibrated or not working. ▶ Alkalinity is low, the pH minus injection may create large pH variations. 	<ul style="list-style-type: none"> ▶ Check the pH level in the pool using photometer or a test strip. ▶ Check the pH sensor wiring on the control box and on the sensor holder. ▶ Check the operation of the sensor using a sensor tester (ask your pool specialist). ▶ Clean and calibrate the sensor. ▶ Replace the sensor. ▶ Check and adjust alkalinity.

Message	Possible Cause	Solution
<p>pH DOSING STOP ("INFO" indicator flashing)</p>	<ul style="list-style-type: none"> ▶ The pH setpoint has not been reached after 5 cumulative hours of injection. ▶ The pH sensor is disconnected, dirty, uncalibrated or not working. ▶ The pH minus container is empty. ▶ The peristaltic pump is not primed. ▶ High alkalinity, acid injection does not help to lower the pH. 	<ul style="list-style-type: none"> ▶ Check the pH level in the pool using photometer or a test strip. ▶ Check the pH sensor wiring on the control box and on the sensor holder. ▶ Check the operation of the sensor using a sensor tester (ask your pool specialist). ▶ Clean and calibrate the sensor. ▶ Replace the pH container. ▶ Test the peristaltic pump (ask your pool specialist). ▶ Replace the pH sensor. ▶ Lower the alkalinity (ask your pool specialist).
<p>ORP STOP ("INFO" indicator flashing)</p>	<ul style="list-style-type: none"> ▶ The ORP setpoint has not been reached after 36 cumulative hours of chlorination. ▶ The ORP sensor is disconnected, dirty, uncalibrated or not working. ▶ When cyanuric acid concentration is too high the efficacy of chlorine is highly reduced. ▶ When cyanuric acid concentration is too high it lowers the ORP reading from the sensor. ▶ pH is too high. ▶ When the total chlorine concentration is too high, chloramines will lower the ORP reading of the sensor. ▶ The device is not correctly sized for the pool. ▶ When the cell is worn, calcified or out of order the electrolysis reaction is not efficient. ▶ Daily filtration and chlorination times are not sufficient 	<ul style="list-style-type: none"> ▶ Check the chlorine level in the pool using photometer or a test strip. ▶ Check the ORP sensor wiring on the control box and on the sensor holder. ▶ Check the operation of the sensor using a sensor tester (ask your pool specialist). ▶ Clean and calibrate the sensor. ▶ Drain the pool using the main drain in order to lower the cyanuric acid concentration. ▶ Proceed to a shock chlorination (using calcium hypochlorite) to reduce the chloramines concentration. ▶ Check the cell conditions. ▶ Replace the ORP sensor. ▶ Increase daily filtration and SWC timers
Firmware Update and Connectivity Troubleshooting		
<div style="border: 1px solid gray; padding: 5px; margin-bottom: 10px;"> <p>Update Timed Out A firmware update is required for your equipment, but we're having trouble downloading it. Make sure the device has a strong Wi-Fi connection before trying again. If you continue to have issues, please contact customer support.</p> <p style="text-align: center;">Cancel Retry</p> </div> <p>or</p> <div style="border: 1px solid gray; padding: 5px;"> <p>Update Timed Out A firmware update is required for your equipment, but we're having trouble downloading it. Make sure the device has a strong Wi-Fi connection before trying again. If you continue to have issues, please contact customer support.</p> <p style="text-align: center;">OK</p> </div> <p>(pop-up window, app)</p>	<ul style="list-style-type: none"> ▶ Firmware update did not complete within the 65 min timeout (weak Wi-Fi signal) 	<ul style="list-style-type: none"> ▶ Verify Wi-Fi signal strength first and correct before restarting the upload. ▶ Place the chlorinator in Standby mode (short press on Standby button). When in Standby mode, only the clock is displayed on the LCD screen and system memory is freed up for the download. ▶ « Cancel / Retry » pop-up is displayed if you stayed in the app. To resolve, click « Retry » to restart the download process. ▶ « OK » pop-up is displayed if you exit / close the app during update process. To resolve, click on « OK », go back to « My Systems » list and restart the update process on the c. ▶ To stop the update process until the next time you log on to the app, click « Cancel » <p>NOTE: The chlorinator cannot be accessed remotely with the app until the firmware update process has been completed.</p>

Table 8. Troubleshooting

NOTES

Fluidra Group Australia Pty Ltd
219 Woodpark Road,
Smithfield NSW2164, Australia
1300 763 021 | www.zodiac.com.au

© 2020 Zodiac Pool Systems LLC..All rights reserved.
ZODIAC is a registered trademark of Zodiac International S.A.S.U., used under license.
All other trademarks are the property of their respective owners. H0633500_REVB

